

Existing Ground Floor

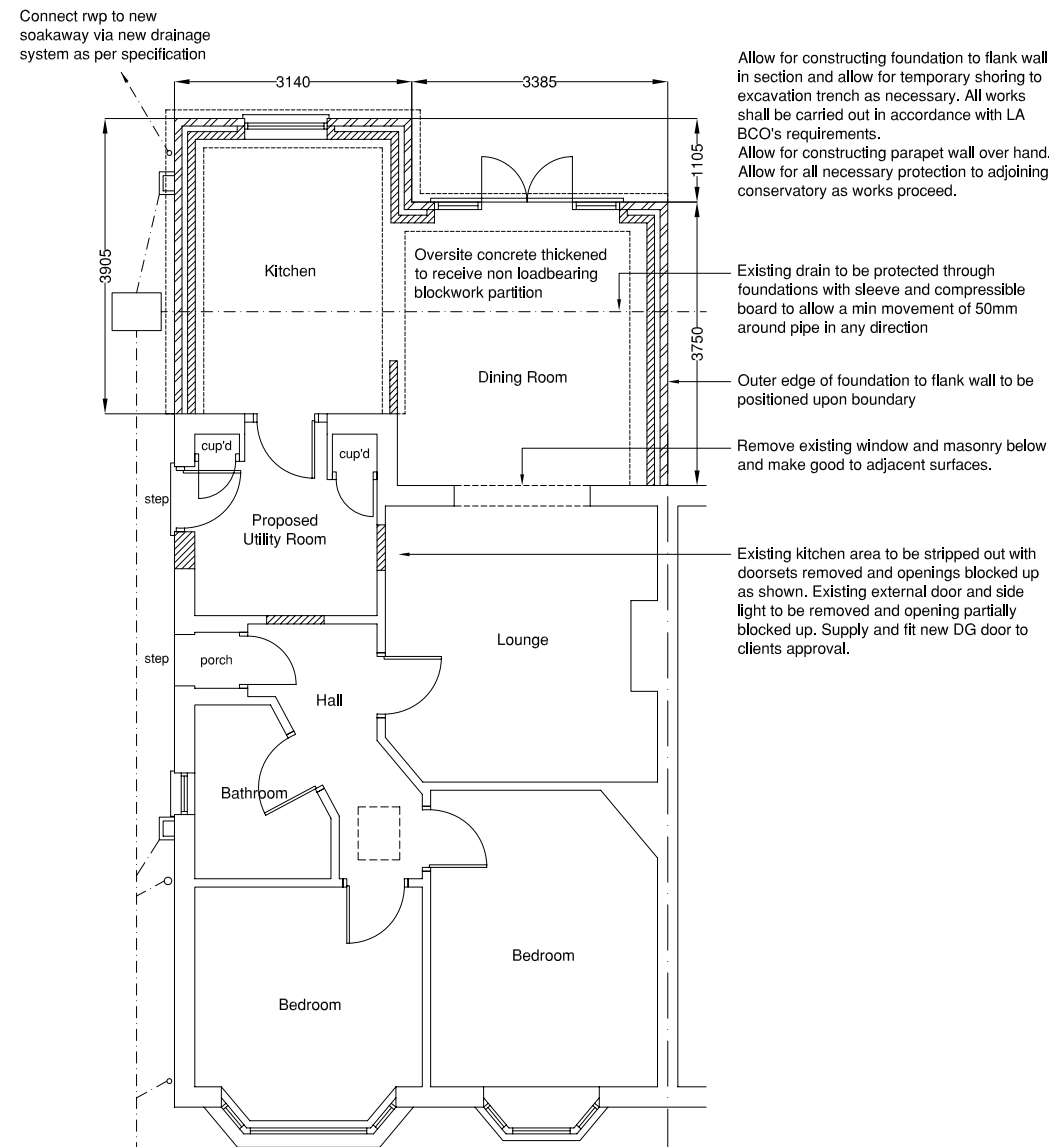

Existing Ground Floor

All work shall be carried out in strict accordance with the British Standard Codes of Practice and respective Manufacturers' Instructions. The location of the boundary shall be confirmed and agreed with the adjacent owner. No part of the works shall be constructed so that it effects a trespass upon the adjacent property. All work shall be undertaken in accordance with the Party Wall agreement 'The Party Wall Act of 1996'. An agreement should also be obtained from the adjoining owner in respect to access to neighbouring property for the purposes of construction.

Original Drawing Size A3

Revision Checked/Dated

## Building Regulations

 **Essan-K Planning Ltd**  
Planning & Design Consultants

8 St Heliers Close, Maidstone, Kent, ME16 8QZ  
Tel: 01622 727237 Email: info@ekplanning.co.uk  
Web: www.ekplanning.co.uk

Project Title:  
**Mr & Mrs Woodford**  
**Shoreham**  
**Kent**

Drawing:  
**Proposed Extension**  
**Existing & Proposed Floorplans**

Date: 23/05/08	Drawing Number:
Scale: 1:100	<b>147-01</b>
Drawn: SDW	
Checked: SDW	Revision:

This drawing is the copyright of Essan-K Planning Ltd and must not be reproduced or used without permission. Figured dimensions to be taken in preference to scaled dimensions and site dimensions must be checked before work is commenced. Copyright reserved.